

Advanced Visualization for First Responders



KUTTA
Technologies for earth and air

Situational Awareness - Virtual Environment (SAVE)

Kutta Technologies provides incident commanders from multiple disciplines (e.g. fire, police, DHS, FBI, FEMA, etc.) with the ability to visualize first responders as they traverse multi-storied structures.

SAVE provides personnel with the ability to annotate the incident scene by simply dragging and dropping standard FEMA symbology (e.g. fire, smoke, enemy) on a comprehensive display in geo-referenced 2D and 3D environments.

Easy-to-use sketching options allow an incident commander to edit a 3D structure in real-time and create a 3D model from scratch in a matter of seconds. (See Reverse Side)

- **Allows Incident Commanders to Track First Responders in a 3D Environment**
- **Provides Easy to Use Annotation Features to Document an Incident in Real-Time (e.g. Fire, Smoke, Stand Pipe Location)**
- **Runs Efficiently on Rugged Laptops**

Contact us today to learn more about this innovative visualization solution.

KuttaTech.com | 1-866-574-9990 | Info@KuttaTech.com

Situational Awareness - Virtual Environment (SAVE)

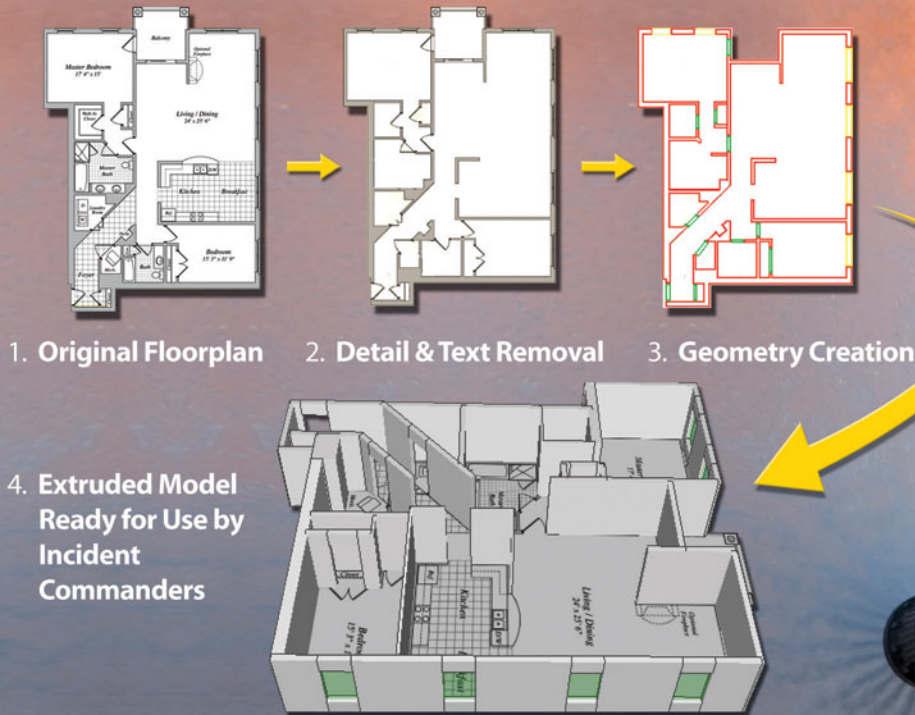

ArchiUp Software

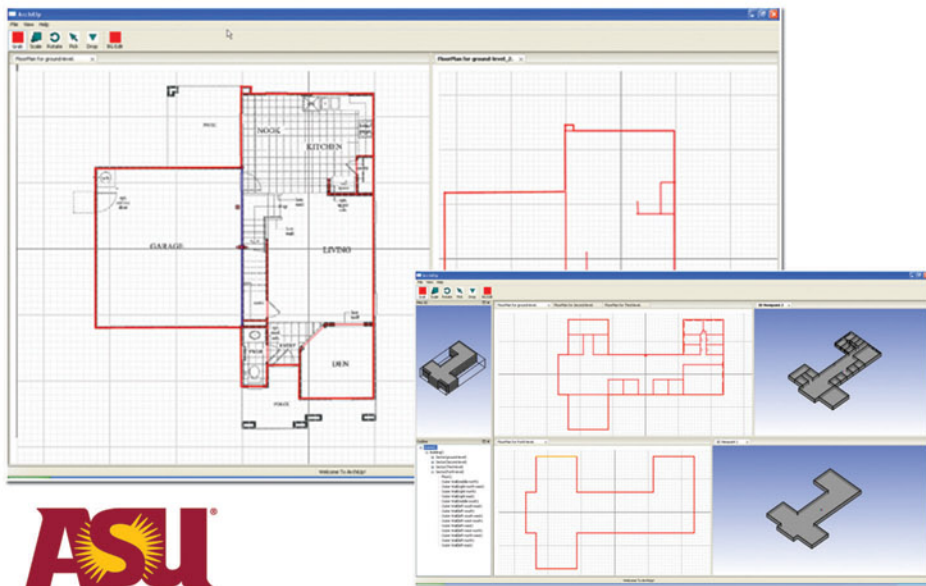

This product was developed with funding from the U.S. Department of Homeland Security via the Small Business Technology Transfer Program, and with the help of Arizona State University.

ArchiUp is a dynamic software tool that generates 2D and 3D building floor plans from paper floor plans or imported Computer-Aided Drafting (CAD) files. ArchiUp allows the user to quickly edit building models and add specific geo-spatial and non-geo-spatial elements.